

Body Type

MO-S5788Z-3D

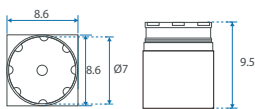

MO-S5788Z-2S

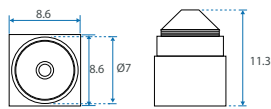

MO-S5788Z-1T

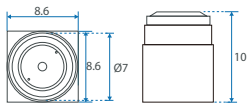

MO-S5788Z-2S

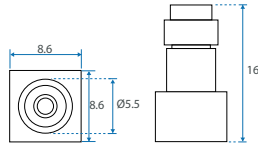

MO-S5788Z-3W

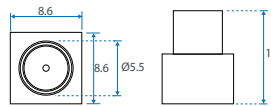

Unit : mm (± 0.5)

Feature

- Super Wide-angle
- Compact size.
- Hi Resolution up to 550 TV Lines.
- High Performance.
- Outstanding Quality!
- Competitive Price!

Specification

Model	MO-S5788Z
Pixel size	6 um x 6 um
Effective Image Area	3.8mm (H) x 2.9mm (V)X4.86mm(D)
Video system	EIA / CCIR
Number of effective pixels	648 x 488 (EIA & CCIR)
Image sensor	1/4" B/W CCIQ II X-ray eyes Camera
Resolution(TV Lines)	550 TV Lines
S/N Ratio	47 dB
Dynamic range	63.3 dB
Sensor scan mode	progressive scan
Minimum illumination	0.006LUX / F1.2
Image Transfer Rate	60 field/sec (EIA), 50 field/sec (CCIR)CVBS
Sensitivity	8.2 [V/Lux.sec]
Horizontal sync frequency	EIA -15.734kHz , CCIR - 15.625kHz
Vertical sync frequency	EIA - 60Hz , CCIR - 50Hz
Camera consumption	0.45
Video output	1Vp-p , 75ohm composite
Storage temperature	-30 to 60 Degree C
Working temperature	-10 to 45 Degree C
Power source	DC 5~12V
Power current	100 mA(max)
Dimension (mm)	8.6 x 8.6 (mm)



▲ MO-S5788Z-3D



▲ MO-S5788Z-2S



▲ MO-S5788Z-2V



▲ MO-S5788Z-3W



▲ MO-S5788Z-3T,
MO-S5788Z-4T

Ordering Information

MODEL	FOCUS LENS	MIC.	LENS THREAD
MO-S5788A-3D	3.9mm / F2.8	External	M 7 mm, P0.35mm
MO-S5788A-2V	2.95mm / F3.2		M 7 mm, P0.5mm
MO-S5788A-3T	3.1mm / F3.4		M 7 mm, P0.5mm
MO-S5788A-4T	3.9mm / F3.9		M 7 mm, P0.5mm
MO-S5788A-2S	2.1mm / F2.5		M 5.5 mm, P0.35mm
MO-S5788A-3W	2.8mm / F3.9		M 5.5 mm, P0.35mm
MO-S5788-3D	3.9mm / F2.8		N/A
MO-S5788-2V	2.95mm / F3.2	M 7 mm, P0.5mm	
MO-S5788-3T	3.1mm / F3.4	M 7 mm, P0.5mm	
MO-S5788-4T	3.9mm / F3.9	M 7 mm, P0.5mm	
MO-S5788-2S	2.1mm / F2.5	M 5.5 mm, P0.35mm	
MO-S5788-3W	2.8mm / F3.9	M 5.5 mm, P0.35mm	

Body Type

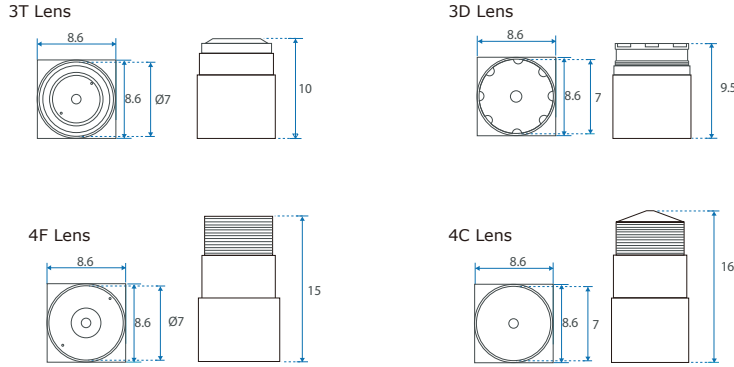

Unit : mm (± 0.5)

Feature

- Backlight compensation.
- Compact size.
- Hi Resolution up to 400 TV Lines.
- High Performance.
- Outstanding Quality!
- X-ray eyes !

Specification

Model	MO-S3788Z
Video system	EIA / CCIR
Number of effective pixels	648 x 488
Image sensor	1/4" CCIQ II B/W X-ray eyes Camera
Resolution(TV Lines)	400 TV Lines
S/N Ratio	more than 50dB
Minimum illumination	0.06 LUX / F1.2
Electronic shutter	60 field/sec (NTSC) , 50 field/sec (PAL)
Horizontal sync frequency	NTSC(EIA) - 15.734kHz , PAL(CCIR) - 15.625kHz
Vertical sync frequency	NTSC(EIA) - 60Hz , PAL(CCIR) - 50Hz
Camera consumption	0.45
Video output	1Vp-p , 75ohm composite
Audio output	Frequency 20-16000Hz,S/N ratio more than 58dB SPL (Ordering in advance)
Storage temperature	-30 to 60 Degree C
Working temperature	-10 to 45 Degree C
Power source	Camera :DC 5~12V
Power current	50 mA-max (DC 12V)
Dimension (mm)	8.6 x 8.6 (mm)



▲ 3T LENS



▲ 3D LENS



▲ 4F LENS



▲ 4C LENS

Ordering Information

MODEL	FOCUS LENS	LENS THREAD
MO-S3788Z-3D	3.9mm / F2.8(SLIM type)	M 7 mm, P0.35mm
MO-S3788Z-3T	3.1mm / F3.4(SLIM type)	M 7 mm, P0.5mm
MO-S3788Z-4F	4.0mm / F3.0(FLAT type)	M 7 mm, P0.5mm
MO-S3788Z-8F	8.3mm / F2.4(FLAT type)	M 7 mm, P0.5mm

NOTE

Cable length : ordering in advance

Other Information

1/4" CCIQ II COLOR Camera ► MO-S3588

NTSC / PAL
PIXEL: 648 x 488(NTSC/PAL)
Resolution: 400 TV Lines
0.1 LUX / F1.2
Dimension:8.6mm x 8.6mm



3T Lens
(3.1mm/F3.4)



3D Lens
(3.9mm/F2.8)



4F Lens
(4.0mm/F2.0)



4C Lens
(4.0mm/F2.0)