

Body Type

MO-S5555-3Z

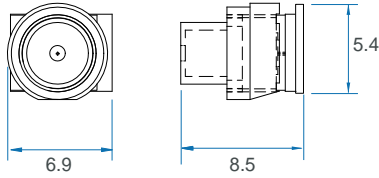

MO-S5555-3D

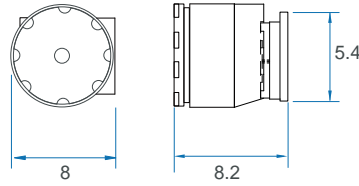

Feature

- Compact size.
- Hi Resolution up to 480 TV Lines.
- High Performance.
- Outstanding Quality!
- Competitive Price!

Unit : mm (± 0.5)

Specification

Model	MO-S5555-3Z	MO-S5555-3D
Pixel size	6 um x 6 um	
Effective Image Area	3.8mm (H) x 2.9mm (V)X4.86mm(D)	
Video system	NTSC / PAL	
Number of effective pixels	648 x 488 (NTSC & PAL)	
Image sensor	1/3.7" CCIQ III Color Camera	
Resolution(TV Lines)	480 TV Lines	
S/N Ratio	47 dB	
Dynamic range	63.3 dB	
Sensor scan mode	progressive scan	
Minimum illumination	0.02LUX / F1.2	
Image Transfer Rate	60 field/sec CVBS(NTSC), 50 field/sec (PAL)	
Sensitivity	8.2 [V/Lux.sec]	
Horizontal sync frequency	NTSC -15.734kHz , PAL - 15.625kHz	
Vertical sync frequency	NTSC - 60Hz , PAL - 50Hz	
Camera consumption	0.45	
Video output	1Vp-p , 75ohm composite	
Built-in Lens	3.4mm /F3.4	3.9mm /F2.8
Storage temperature	-30 to 60 Degree C	
Working temperature	-10 to 45 Degree C	
Power source	DC 5~12V	
Power current	100 mA(max)	
Dimension (mm)	6.9 x 8.5 x 5.4(mm)	6.9 x 8.5 x 5.4(mm)



▲ MO-S5555-3Z

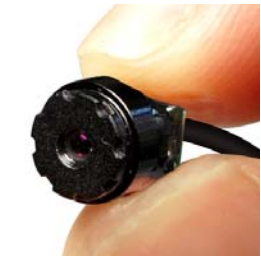

▲ MO-S5555-3D

Ordering Information

MODEL	LENS	Thread pitch	NOTE
MO-S5555-3Z	3.4mm / F3.4	M5 / P0.35 mm	1/4" CCIQ III Color
MO-S5555-3D	3.9mm / F2.8	M7 / P0.35 mm	
MO-S5555-3W	2.8mm / F2.8	M7 / Top5 / P0.5 mm	
MO-S5555-3X	3.4mm / F2.8	M6 / P0.35 mm	
MO-S5755-3Z	3.4mm / F3.4	M5 / P0.35 mm	1/4" CCIQ III B/W
MO-S5755-3D	3.9mm / F2.8	M7 / P0.35 mm	
MO-S5755-3W	3.9mm / F2.8	M7 / Top5 / P0.5 mm	
MO-S5755-3X	3.4mm / F2.8	M6 / P0.35 mm	

Note:

Minimum illumination (**COLOR**) : 0.02 Lux/ F1.2

Minimum illumination (**B/W**) : 0.006 Lux/ F1.2

Body Type

MO-S5755-3Z

MO-S5755-3D

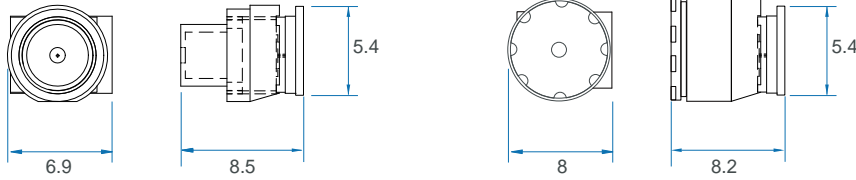

Feature

- Compact size.
- Hi Resolution up to 550 TV Lines.
- High Performance.
- Outstanding Quality!
- Competitive Price!

Specification

Unit : mm (± 0.5)

Model	MO-S5755-3Z	MO-S5755-3D
Pixel size	6 um x 6 um	
Effective Image Area	3.8mm (H) x 2.9mm (V)X4.86mm(D)	
Video system	EIA / CCIR	
Number of effective pixels	648 x 488 (EIA / CCIR)	
Image sensor	1/3.7" CCIQ III B/W Camera	
Resolution(TV Lines)	550 TV Lines	
S/N Ratio	47 dB	
Dynamic range	63.3 dB	
Sensor scan mode	progressive scan	
Minimum illumination	0.006 Lux/F1.2	
Image Transfer Rate	60 field/sec CVBS(EIA), 50 field/sec (CCIR)	
Sensitivity	8.2 [V/Lux.sec]	
Horizontal sync frequency	EIA -15.734kHz, CCIR - 15.625kHz	
Vertical sync frequency	EIA - 60Hz, CCIR - 50Hz	
Camera consumption	0.45	
Video output	1Vp-p, 75ohm composite	
Built-in Lens	3.4mm /F3.4	3.9mm /F2.8
Storage temperature	-30 to 60 Degree C	
Working temperature	-10 to 45 Degree C	
Power source	DC 5~12V	
Power current	100 mA(max)	
Dimension (mm)	6.9 x 8.5 x 5.4(mm)	6.9 x 8.5 x 5.4(mm)



▲ MO-S5755-3Z



▲ MO-S5755-3D

Ordering Information

MODEL	LENS	Thread pitch	NOTE
MO-S5755-3Z	3.4mm / F3.4	M5 / P0.35 mm	1/3.7" CCIQ III B/W
MO-S5755-3D	3.9mm / F2.8	M7 / P0.35 mm	
MO-S5755-3W	2.8mm / F2.8	M7 / Top5 / P0.5 mm	
MO-S5755-3X	3.4mm / F2.8	M6 / P0.35 mm	
MO-S5755-2V	2.8mm / F3.9	M7 / P0.5 mm	
MO-S5755-6F	6.34mm/F4.4	M7 / P0.5 mm	
MO-S5555-3Z	3.4mm / F3.4	M5 / P0.35 mm	1/3.7" CCIQ III Color
MO-S5555-3D	3.9mm / F2.8	M7 / P0.35 mm	
MO-S5555-3W	3.9mm / F2.8	M7 / Top5 / P0.5 mm	
MO-S5555-3X	3.4mm / F2.8	M6 / P0.35 mm	
MO-S5555-2V	2.8mm / F3.9	M7 / P0.5 mm	
MO-S5555-6F	6.34mm / F4.4	M7 / P0.5 mm	

Body Type

MO-B5755-3Z

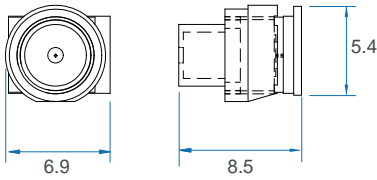

MO-B5755-3D

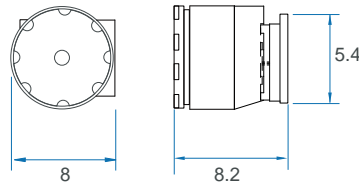

Feature

- Compact size.
- Hi Resolution up to 550 TV Lines.
- High Performance.
- Outstanding Quality!
- Competitive Price!

Unit : mm (± 0.5)

Specification

Model	MO-B5755-3Z	MO-B5755-3D
Pixel size	6 um x 6 um	
Effective Image Area	3.8mm (H) x 2.9mm (V)X4.86mm(D)	
Video system	EIA / CCIR	
Number of effective pixels	648 x 488 (EIA / CCIR)	
Image sensor	1/3.7" CCIQ III Color Camera	
Resolution(TV Lines)	550 TV Lines	
S/N Ratio	47 dB	
Dynamic range	63.3 dB	
Sensor scan mode	progressive scan	
Minimum illumination	0.006 Lux/F1.2	
Image Transfer Rate	60 field/sec CVBS(EIA), 50 field/sec (CCIR)	
Sensitivity	8.2 [V/Lux.sec]	
Horizontal sync frequency	NTSC -15.734kHz , PAL - 15.625kHz	
Vertical sync frequency	NTSC - 60Hz , PAL - 50Hz	
Camera consumption	0.45	
Video output	1Vp-p , 75ohm composite	
Built-in Lens	3.4mm /F3.4	3.9mm /F2.8
Storage temperature	-30 to 60 Degree C	
Working temperature	-10 to 45 Degree C	
Power source	DC 5-12V	
Power current	100 mA(max)	
Dimension (mm)	6.9 x 8.5 x 5.4(mm)	6.9 x 8.5 x 5.4(mm)



▲ MO-B5755-3Z



▲ MO-B5755-3D

Ordering Information

MODEL	LENS	Thread pitch	NOTE
MO-B5755-3Z	3.4mm / F3.4	M5 / P0.35 mm	1/3.7" CCIQ III Color
MO-B5755-3D	3.9mm / F2.8	M7 / P0.35 mm	
MO-B5755-3W	2.8mm / F2.8	M7 / Top5 / P0.5 mm	
MO-B5755-3X	3.4mm / F2.8	M6 / P0.35 mm	
MO-B5755-2V	2.8mm / F3.9	M7 / P0.5 mm	
MO-B5755-6F	6.34mm/F4.4	M7 / P0.5 mm	
MO-B5555-3Z	3.4mm / F3.4	M5 / P0.35 mm	1/3.7" CCIQ III B/W
MO-B5555-3D	3.9mm / F2.8	M7 / P0.35 mm	
MO-B5555-3W	3.9mm / F2.8	M7 / Top5 / P0.5 mm	
MO-B5555-3X	3.4mm / F2.8	M6 / P0.35 mm	
MO-B5555-2V	2.8mm / F3.9	M7 / P0.5 mm	
MO-B5555-6F	6.34mm / F4.4	M7 / P0.5 mm	