

Body Type

MO-S5788-3D

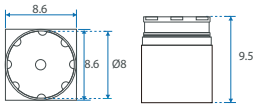

MO-S5788-2V

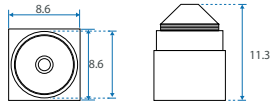

MO-S5788-3M
MO-S5588-3X6

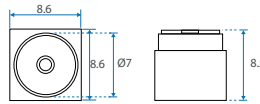

MO-S5788-3T

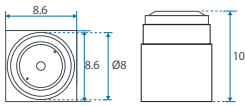

MO-S5788-2S

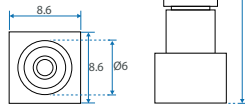

MO-S5788-3K

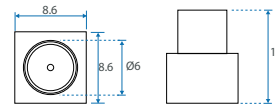

MO-S5788-2E

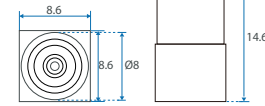

Specification

Unit : mm (± 0.5)

| | |
|----------------------------|---|
| Model | MO-S5788 |
| Pixel size | 6 um x 6 um |
| Effective Image Area | 3.8mm (H) x 2.9mm (V)X4.86mm(D) |
| Video system | EIA / CCIR |
| Number of effective pixels | 648 x 488 (EIA & CCIR) |
| Image sensor | 1/4" CCIQ III Color Camera |
| Resolution(TV Lines) | 550 TV Lines |
| S/N Ratio | 47 dB |
| Dynamic range | 63.3 dB |
| Sensor scan mode | progressive scan |
| Minimum illumination | 0.006LUX / F1.2 |
| Image Transfer Rate | 60 field/sec CVBS(EIA), 50 field/sec (CCIR) |
| Sensitivity | 8.2 [V/Lux.sec] |
| Horizontal sync frequency | EIA - 15.734kHz, CCIR - 15.625kHz |
| Vertical sync frequency | EIA - 60Hz, CCIR - 50Hz |
| Camera consumption | 0.45 |
| Video output | 1Vp-p, 75ohm composite |
| Storage temperature | -30 to 60 Degree C |
| Working temperature | -10 to 45 Degree C |
| Power source | DC 5~12V |
| Power current | 100 mA(max) |
| Dimension (mm) | 8.6 x 8.6 (mm) |



▲ MO-S5788-3D



▲ MO-S5788-2S
MO-S5788-2ES



▲ MO-S5788-2V



▲ MO-S5788-3K



▲ MO-S5788-3T,
MO-S5788-4T



▲ MO-S5788-3M,
MO-S5788-3X6



▲ MO-S5788-2E

Ordering Information

| MODEL | FOCUS LENS | MIC. | LENS THREAD |
|---------------|------------------------------|----------|------------------|
| MO-S5788A-3D | 3.9mm / F2.8 | External | M7 mm, P0.5mm |
| MO-S5788A-2V | 2.95mm / F3.2 | External | M7 mm, P0.5mm |
| MO-S5788A-3T | 3.1mm / F3.4 | External | M7 mm, P0.5mm |
| MO-S5788A-4T | 3.9mm / F3.9 | External | M7 mm, P0.5mm |
| MO-S5788A-2S | 2.1mm / F2.5 | External | M5.5 mm, P0.35mm |
| MO-S5788A-3K | 2.8mm / F3.9 | External | M5.5 mm, P0.35mm |
| MO-S5788A-3X6 | 3.4mm / F6.0 High DOF | External | M6 , P0.35mm |
| MO-S5788A-3M | 3.4mm / F2.8 | External | M6 , P0.35mm |
| MO-S5788A-2E | 2.3mm / F2.6 | External | M7 mm, P0.5mm |
| MO-S5788A-2ES | 2.3mm / F2.6 | External | M5.5 mm, P0.35mm |

NOTE:
MO-S5788A-3D ▲: external microphone