

Body Type

MX-B5X09K-3D

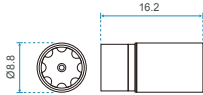

MX-B5X09K-4F

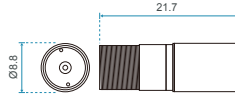

MX-B5X09K-3G2

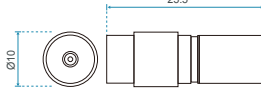

MX-B5509K-2S & MX-B5709K-2S

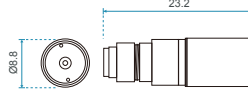

Specification

unit : mm (±1)

Model	MX-B5509K	MX-B5709K	MX-B5609K	MX-B5909K
Video system	NTSC / PAL	EIA / CCIR	NTSC / PAL	EIA / CCIR
Number of effective pixels	648(H) x 488(V) (NTSC & PAL)	648(H) x 488(V) (EIA & CCIR)	728(H) x 488(V) (NTSC & PAL)	728(H) x 488(V) (EIA & CCIR)
Image sensor	1/3.7" Hybrid sensitivity color camera	1/3.7" Hybrid sensitivity B/W camera	1/3" Hybrid sensitivity color camera	1/3" Hybrid sensitivity B/W camera
Resolution(TV Lines)	480 TV Lines	550 TV Lines	480 TV Lines	550 TV Lines
S/N Ratio	47 dB		46.4 dB	
Max Dynamic Range	63.3 [dB]		63.7 [dB]	
Sensor scan mode	progressive scan			
Minimum illumination	0.02Lux / F 1.2 20IRE 0.5 Lux / 74.5IRE, 15 fps ; 0.5 Lux / 63.2IRE, 30 fps		0.05Lux / F1.2 20IRE	
Frame Rate	15 fps			
Sensitivity	8.2 [V/Lux.sec]			
Horizontal sync frequency	NTSC/EIA -15.734kHz , PAL/CCIR - 15.625kHz			
Vertical sync frequency	NTSC/EIA - 60Hz , PAL/CCIR - 50Hz			
Camera consumption	0.45			
Video output	1Vp-p , 75ohm composite			
Storage temperature	-30 to 60 Degree C			
Working temperature	-10 to 45 Degree C			
Power source	Camera input: DC 3.3 V			
Power current	170 mA(max)			

Feature

- High Sensitivity!
- High Performance.
- Low light intensive camera
- 480 TV lines
- Compact size



MX-B5X09K-3D



MX-B5X09K-4F



MX-B5X09K-3G2



MX-B5509K-2S
MX-B5709K-2S

Ordering information

MODEL	Built-in Lens	Frame rate	Note
MX-B5X09K-3D	3.9mm/F2.8	15 fps	MX-B5509KA-3D A : with microphone ● 2S (2.1mm/F2.5)lens available for MX-B5509-2S and MX-B5709-2S ● 2E (2.3mm/F2.6)lens available for MX-B5509-2E and MX-B5709-2E
MX-B5X09K-3T	3.1mm/F3.4		
MX-B5X09K-4T	3.9mm/F3.9		
MX-B5X09K-2V	2.8mm/F3.9		
● MX-B5X09K-2S	2.1mm/F2.5		
MX-B5X09K-4D	4.8mm/F4.5		
MX-B5X09K-5F	5.0mm/F3.5		
MX-B5X09K-6F	6.38mm/F4.4		
MX-B5X09K-3G2	3.6m/F2.0 (G-Type Lens)		
● MX-B5X09-2E	2.3mm/F2.6		
MX-B5X09-3D	3.9mm/F2.8	30 fps	
MX-B5X09-3T	3.1mm/F4.5		
MX-B5X09-4T	3.9mm/F3.9		
MX-B5X09-2V	2.8mm/F3.9		
● MX-B5X09-2S	2.1mm/F2.5		
MX-B5X09-4D	4.8mm/F4.5		
MX-B5X09-5F	5.0mm/F3.5		
MX-B5X09-6F	6.38mm/F4.4		
MX-B5X09-3G2	3.6m/F2.0 (G-Type Lens)		
● MX-B5X09-2E	2.3mm/F2.6		

Other information

MX-R5610C

- 1/3" CCIQ III
- Non-detectable(AR lens) !
- Hybrid sensitivity camera

1/3" Color CCIQ III Camera
 Pixel : 728 x 488 (NTSC / PAL)
 480 TV Lines

