

UNIT: mm

Specification

Model	L3620ARS-C8M9	L3620IRS-C8M9
Sensor type	1/3"	
Focal length	3.6mm	
Image circle	Ø6.0 mm ±5%	
FBFL	4.04mm	
Aperture F/no	2.0	
F.O.V (D/H/V)	92° / 73° / 54°	
Total Track	14.33	
Mount	M9 x P0.5	
Lens construction	4G	
IR Filter	N/A	650nm

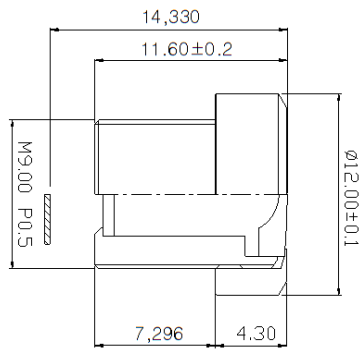

UNIT: mm

Specification

Model	L3620IRS-C12M9	L3620IRS-C12M9
Sensor type	1/3"	
Focal length	3.6mm	
Image circle	Ø6.0 mm ±5%	
FBFL	4.04mm	
Aperture F/no	2.0	
F.O.V (D/H/V)	92° / 73° / 54°	
Total Track	14.33	
Mount	M9 x P0.5	
Lens construction	4G	
IR Filter	N/A	650nm

