

MO-V3506L

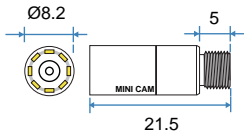

MO-V5506L

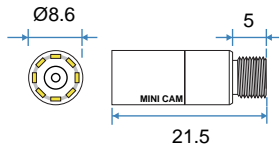

MO-V5006L

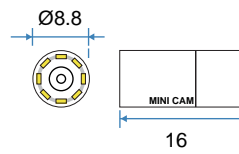

MO-V5606L

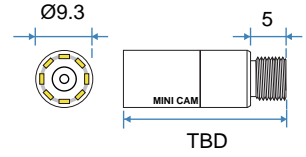

**Specification**

Model	MO-V3506L	MO-V5506L	MO-V5006L	MO-V5606L
Number of effective pixels	648 (H) x 488(V) (NTSC / PAL)		712x552 (640x480 output pixel array)	728 (H) x 488(V) (NTSC / PAL)
Image circle	4.5mm	4.86mm	5.0mm	5.97mm
Pixel Size	5.55 um x 5.55 um	6 um x 6 um	5.6 um x 5.6 um	6.35 um x 7.4 um
Image sensor	1/4" Color CCIQ	1/3.7" Color CCIQ	1/4" Color CCIQ	1/3" Color CCIQ
S/N Ratio	45.6 [dB]	47.0 [dB]	44.8 dB	46.4 [dB]
Dynamic range	63.5 [dB]	63.3 [dB]	75 dB	63.7 [dB]
Sensitivity	3.16 [V/Lux.sec]	8.2 [V/Lux.sec]	16 [V/Lux.sec]	13.8 [V/Lux.sec]
Dimension (mm)	Ø8.2 mm	Ø8.6 mm	Ø8.8 mm	Ø9.3 mm
Montion detect function	N/A	N/A	N/A	N/A
UTC function	N/A	N/A	YES	N/A
Video system	NTSC / PAL			
Frame Rate	60 Field/sec(NTSC) , 50 Field/sec(PAL)			
Horizontal sync frequency	NTSC -15.734kHz , PAL - 15.625kHz			
Vertical sync frequency	NTSC - 60Hz , PAL - 50Hz			
Camera consumption	0.45			
Video output	1Vp-p , 75ohm composite			
Storage temperature	-30 to 60 Degree C			
Working temperature	-10 to 45 Degree C			
Power source	Camera input: DC 5~12V			
Power current	80mA			

**Lens Information**

Model	Object distance	Focal length	F stop	Image circle	DOF
L23026IR-M5.5-53	>10cm	2.3mm	2.6	5.16	Short
L23070IR-M5.5-53	5~10cm	2.3mm	7.0	5.16	Medium
L23010IR-M5.5-53	<5cm	2.3mm	10	5.16	Long
LP3434IR-M5.5	>10cm	3.4mm	2.6	4.8	Short
LP3470IR-M5.5	5~10cm	3.4mm	7.0	4.8	Medium

• Suggest to with LED light

**LED Information**

MODEL	LED	Type
MO-V3506L	white LEDx8	color
MO-V92706L	IR 940nm LEDx8	B/W
MO-V82706L	IR 850nm LEDx8	B/W
MO-V5506L	white LEDx8	color
MO-V95706L	IR 940nm LEDx8	B/W
MO-V85706L	IR 850nm LEDx8	B/W
MO-V5006L	white LEDx8	color
MO-V97006L	IR 940nm LEDx8	B/W
MO-V87006L	IR 850nm LEDx8	B/W
MO-V5606L	white LEDx8	color
MO-V95906L	IR 940nm LEDx8	B/W
MO-V85906L	IR 850nm LEDx8	B/W

**Connector Information**

MQ-	JQ-	MJ-	MQ-	
				<p>G : GND                      A : AUDIO                      P : DC POWER                      V : VIDEO</p>

With Dimmer switch to adjust light source

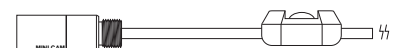

MO-B3506

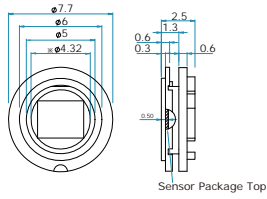

MO-B5506

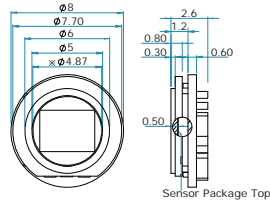

MO-B5006

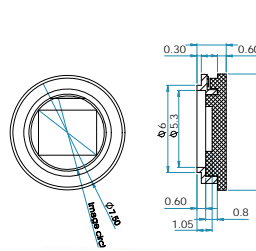

MO-B5606

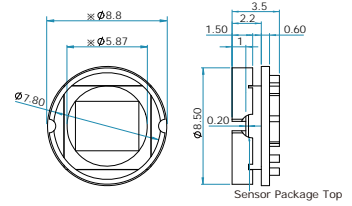

Unit : mm (± 0.1)

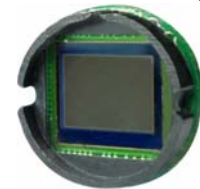

## Specification

Model	MO-B3506	MO-B5506	MO-B5006	MO-B5606
Video system	NTSC / PAL		NTSC / PAL	NTSC / PAL
Number of effective pixels	648 (H) x 488(V) (NTSC / PAL)		712 x 552 (NTSC & PAL)	728 (H) x 488(V) (NTSC / PAL)
Image circle	4.5mm	4.86mm	5.0mm	5.97mm
Pixel Size	5.55 um x 5.55 um	6 um x 6 um	5.6 um x 5.6 um	6.35 um x 7.4 um
Image sensor	1/4" Color CCIQ	1/3.7" Color CCIQ	1/3.56" Color CCIQ	1/3" Color CCIQ
S/N Ratio	45.6 [dB]	47.0 [dB]	44.8 dB	46.4 [dB]
Dynamic range	63.5 [dB]	63.3 [dB]	75 dB	63.7 [dB]
Sensitivity	3.16 [V/Lux.sec]	8.2 [V/Lux.sec]	16 [V/Lux.sec]	13.8 [V/Lux.sec]
Dimension (mm)	Ø7.7 mm	Ø8 mm	Ø8.6 mm	Ø8.8 mm
Montion detect function	N/A	N/A	YES	N/A
UTC function	N/A	N/A	YES	N/A
Frame Rate	60 Field/sec(NTSC) , 50 Field/sec(PAL)			
Horizontal sync frequency	NTSC -15.734kHz , PAL - 15.625kHz			
Vertical sync frequency	NTSC - 60Hz , PAL - 50Hz			
Camera consumption	0.45			
Video output	1Vp-p , 75ohm composite			
Storage temperature	-30 to 60 Degree C			
Working temperature	-10 to 45 Degree C			
Power source	Camera input: DC 3.3~4.2V (suggest DC 3.3V)			
Power current	100mA			

## Ordering Information

Type	Built-in Lens	Lens image circle	Thread pitch
3S	3.4mm/F3.4	4.8mm	M5.5 X P0.35
3X6	3.4mm/F6.0	4.8mm	M6 X P0.35
3X	3.4mm/F2.8	4.8mm	M6 X P0.35
3W	2.8mm/F3.9	6.0mm	M7/TOP5 X P0.5
2S	2.1mm/F2.5	4.0mm	M5.5 X P0.35
3D	2.1mm/F2.5	5.9mm	M5.5 X P0.35
2V	2.8mm/F3.9	4.86mm	M7 X P0.5
8F	8.3mm/F2.4	6.0mm	M7 X P0.5
2E	2.3mm/F2.6	5.16mm	M7/TOP5.3 X P0.5
2ES	2.3mm/F2.6/F7.0/F10	5.16mm	M5.5/TOP5.3 X P0.35

## Other Information

1/3" Color CCIQ III 960H Camera  
 710 TV Line over (NTSC) ,  
 740 TV Line over (PAL)  
 Sensitivity: 11.4 [V/Lux.sec]



▲ MO-B8622

▲ MO-B8619

▲ MO-B8626