

UP VIEW TYPE

Module type
MX-B4109U

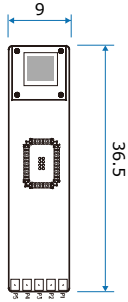

with case
MX-N4110U

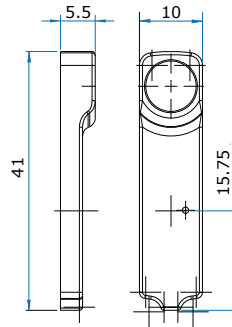

UNIT:±0.5mm

Feature

- H.264 video format
- Driver free (USB Video Class) for any OS (windows XP · Vista · win7, Linux any version, MAC OS , Andriod phone)

Specification

Features:	<ul style="list-style-type: none"> ● Connects to Windows XP machines USB 2.0 port ● TCP Video MJPEG stream 1280 x 720 /YUV 10fps/ MJPEG 30fps/H.264 24fps 640 x 480 /30 fps; 640 x 360 /30 fps; 320 x 240 /30 fps; 320 x 180 /30 fps ● Driver free (USB Video Class) for any OS (windows XP Linux any version, MAC OS) 	
Model	MD-B4109U	MD-N4110U
Dimension(mm)	Ø10 x 36.5mm	Ø10 x 41mm
Pixel size	3 umx3 um	
Image sensor	1/4" WXGA HD 720P Camera	
Image area	3888 um x 2430 um	
S/N Ratio	39 dB	
Scan mode	progressive	
Sensitivity	3300mV/(Lux)	
Dark Current	20 mV/Sec	
Storage temperature	-30 to 60 Degree C	
Working temperature	-10 to 45 Degree C	
Built-in Lens	4.0mm /F2.0- ordering in advance	
LED	white light LED x 10- ordering in advance	
Power source	DC 5V	
Power current	150 mA	
Microphone	Yes	



MD-N4110U-3X
 (with LP3428IR-M6 Lens)

MODEL	OUTPUT
MD-B4109LU	USB 2.0 A type
MD-N4110U	
MD-N4110LU	
MM-B4109LU	Micro USB OTG B type
MM-N4110U	
MM-N4110LU	

Lens Model	Lens SPEC.	Thread(mm)
L23026IR-M7-53	2.3mm/F2.6	M7/top5.3xP0.5
LP3428IR-M6	3.4mm/F2.8	M6 x P0.35
LP2839IR-M7	2.8mm/F3.9	M7/top4 x P0.5
LP4020IR-M7	4.0mm/F2.0	M7 x P0.5
LP5035IRF-M7	5.0mm/F3.5	M7 x P0.5
LP8324IR-M7	8.3mm/F2.4	M7 x P0.5

UP VIEW TYPE

Module type
MX-B4109U

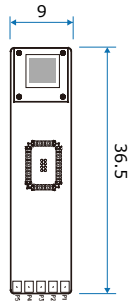

with case
MX-N4110U

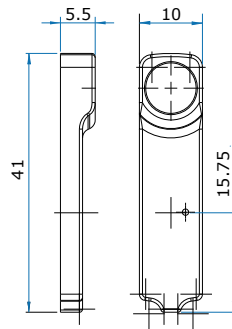

UNIT:±0.5mm

Feature

- H.264 video format
- Driver free (USB Video Class) for any OS (windows XP · Vista · win7, Linux any version, MAC OS , Andriod phone)

Specification

Features:	<ul style="list-style-type: none"> ● Connects to Windows XP machines USB 2.0 port ● TCP Video MJPEG stream 1280 x 720 /YUV 10fps/ MJPEG 30fps/H.264 24fps 640 x 480 /30 fps; 640 x 360 /30 fps; 320 x 240 /30 fps; 320 x 180 /30 fps ● Driver free (USB Video Class) for any OS (windows XP Linux any version, MAC OS) 	
Model	MD-B4109U	MD-N4110U
Dimension(mm)	Ø10 x 36.5mm	Ø10 x 41mm
Pixel size	3 umx3 um	
Image sensor	1/4" WXGA HD 720P Camera	
Image area	3888 um x 2430 um	
S/N Ratio	39 dB	
Scan mode	progressive	
Sensitivity	3300mV/(Lux)	
Dark Current	20 mV/Sec	
Storage temperature	-30 to 60 Degree C	
Working temperature	-10 to 45 Degree C	
Built-in Lens	4.0mm /F2.0- ordering in advance	
LED	white light LED x 10- ordering in advance	
Power source	DC 5V	
Power current	150 mA	
Microphone	Yes	



MD-N4110U-3X
 (with LP3428IR-M6 Lens)

MODEL	OUTPUT
MD-B4109LU	USB 2.0 A type
MD-N4110U	
MD-N4110LU	
MM-B4109LU	Micro USB OTG B type
MM-N4110U	
MM-N4110LU	

Lens Model	Lens SPEC.	Thread(mm)
L23026IR-M7-53	2.3mm/F2.6	M7/top5.3xP0.5
LP3428IR-M6	3.4mm/F2.8	M6 x P0.35
LP2839IR-M7	2.8mm/F3.9	M7/top4 x P0.5
LP4020IR-M7	4.0mm/F2.0	M7 x P0.5
LP5035IRF-M7	5.0mm/F3.5	M7 x P0.5
LP8324IR-M7	8.3mm/F2.4	M7 x P0.5